

K36 TYPE -40°C +85°C 100000H

- Long lifetime.
- High ripple current.
- Low ESR, Low Ls.
- Strong Self-healing.

APPLICATIONS

Inverters for wind power and solar power, electric vehicles and hybrid vehicles, SVG, Inverter, UPS, Welding machines.

GENERAL INFORMATION

Reference	GB/T17702, IEC61071
IEC climatic	40/85/21 IEC 68-1
Storage temperature	-40°C to +85°C
Temperature range	-40°C to +85°C
Voltage range	500V to 4000V DC
Capacitance range	20μF to 5600μF
Max Tangent of loss angle	2×10^{-4}
Case	Aluminium case with or without stud M12
Maximum screw torque strength for insert	5Nm for M6, 6Nm for M8
Maximum screw torque strength for installation	10 Nm
Insulation resistance	$IR_{xCap} \geq 5000S$ (at $20 \pm 5^\circ C$ 100VDC, 60s)
Withstanding voltage between terminal and case	$V_n \leq 1500VDC$, 3000VAC (60S, 50Hz, $20 \pm 5^\circ C$) $V_n \geq 1500VDC$ ($2V_i + 1000VAC$, 60S, 50Hz, $20 \pm 5^\circ C$)
Withstanding voltage between terminals	$2V_i + 1000VAC$, $1.5V_n$ (60S, $20 \pm 5^\circ C$)
Over voltage	1.1Vn 30% of on-load-dur 1.15Vn 30min/day 1.2Vn 5min/day 1.3Vn 1min/day
Tolerance (digit 12 th)	“K” = -10%, +10%, “J” = -5% +5% under request
Mounting	Horizontal - Vertical
Maximum ripple current	100A
Max Altitude	2000 m
Life Expectancy	100000 Hours at Nominal voltage 70°C
Failure Rate	100 FIT
End life criteria	+/-10% cap

Note when altitude exceeds 2000m:

The effect of altitude on convection cooling and external insulation should be taken into consideration.

MECHANICAL SPECIFICATIONS

FLAT BOTTOM style

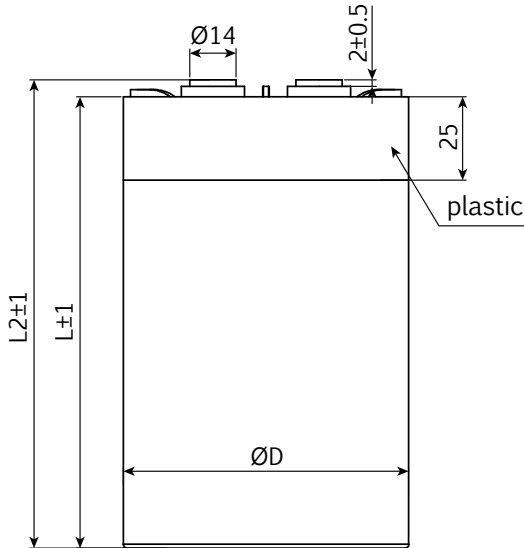

STUD style

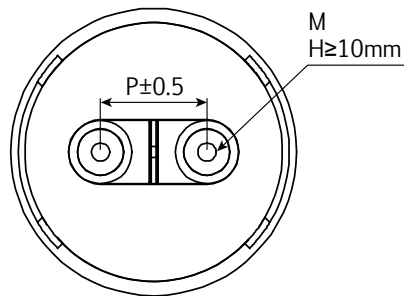
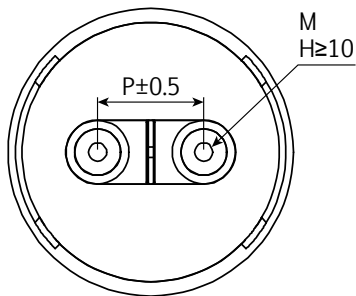
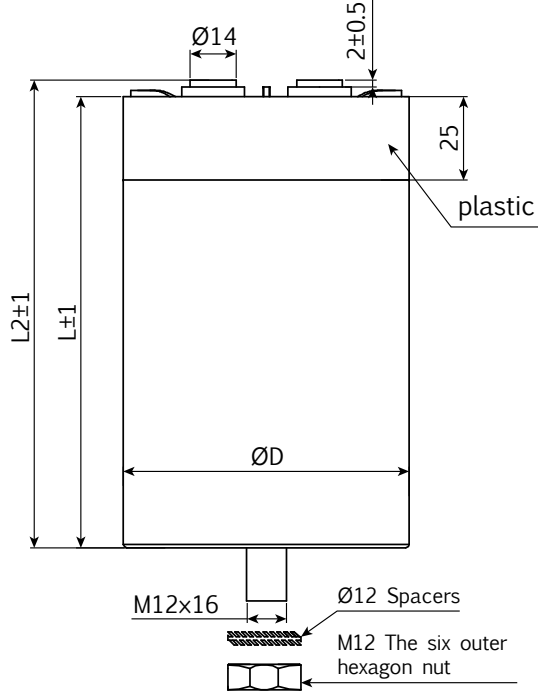

M6 Screw

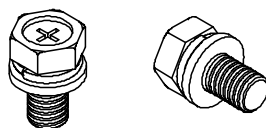

Diagram of dimensions (unit=mm)

K36 TYPE STANDARD RATINGS

Cap. µF	Ø x L mm	ESR mΩ	Ls nH	I _{peak} A	R _{th} K/W	I _{rms} 10kHz 45°C A	PART NUMBER Termination digit excluded
480	76x95	1.5	45	1560	5.7	70	K36600481_K0J095
650	76x120	1.8	45	1560	4.6	70	K36600651_K0J120
650	86x95	1.3	45	2120	5.1	70	K36600651_K0Q095
780	76x140	2.2	40	1550	4.7	80	K36600781_K0J140
820	76x155	1.5	40	3060	4.3	70	K36600821_K0J155
1000	86x140	1.7	50	2070	4.6	70	K36600102_K0Q140
1100	86x140	1.7	40	4110	4.5	70	K36600112_K0Q140
1500	116x140	1.6	40	2740	3.9	80	K36600152_K0T140
2000	116x140	1.2	45	8100	4.8	80	K36600202_K0T140
2400	116x175	0.9	50	7810	3.5	100	K36600242_K0T175
3000	116x230	0.8	60	11200	2.8	100	K36600302_K0T230

**RATED
VOLTAGE
VDC**

600V

Cap. µF	Ø x L mm	ESR mΩ	Ls nH	I _{peak} A	R _{th} K/W	I _{rms} 10kHz 45°C A	PART NUMBER Termination digit excluded
200	76x72	3	40	1000	6.2	40	K36800201_K0J072
330	76x117	1.3	45	3960	5.6	60	K36800331_K0J117
420	76x147	1.4	40	4200	4.7	60	K36800421_K0J147
470	86x122	1.3	50	4700	3.2	60	K36800471_K0Q122
490	86x125	0.9	40	4900	3.5	70	K36800491_K0Q125
500	86x122	3.5	75	5000	3.3	50	K36800501_K0Q122
500	116x80	3	40	4500	3.3	70	K36800501_K0T080
550	86x122	3.5	75	3850	3.6	70	K36800551_K0Q122
650	86x145	1.6	40	5200	4.4	70	K36800651_K0Q145
750	86x175	1.6	50	6750	4.3	70	K36800751_K0Q175
1000	96x175	1.5	50	8000	3	80	K36800102_K0R175
1000	116x125	1.2	60	4000	2.9	80	K36800102_K0T125
1100	86x250	1.2	50	7700	3	70	K36800112_K0Q250
1100	116x145	1.2	40	6600	2.5	90	K36800112_K0T145
1500	116x175	1	50	9000	2.5	100	K36800152_K0T175
2000	116x230	0.8	60	18000	2	100	K36800202_K0T230
2750	136x230	0.7	60	19250	1.8	100	K36800272_K1U230
3500	136x335	0.4	60	12250	1.2	100	K36800352_K0U335

**RATED
VOLTAGE
VDC**

800V

K36 TYPE STANDARD RATINGS

Cap. μF	Ø x L mm	ESR mΩ	Ls nH	I _{peak} A	R _{th} K/W	I _{rms} 10kHz 45°C A	PART NUMBER Termination digit excluded
200	76x72	3	40	1000	6.2	40	K36900201_K0J072
330	76x117	1.3	45	3960	5.6	60	K36900331_K0J117
420	76x147	1.4	40	4200	4.7	60	K36900421_K0J147
470	86x122	1.3	50	4700	3.2	60	K36900471_K0Q122
490	86x125	0.9	40	4900	3.5	70	K36900491_K0Q125
500	86x122	3.5	60	5000	3.3	50	K36900501_K0Q122
500	116x80	3	40	4500	3.3	70	K36900501_K0T080
550	86x122	3.5	60	3850	3.6	70	K36900551_K0Q122
650	86x145	1.6	40	5200	4.4	70	K36900651_K0Q145
750	86x175	1.6	50	6750	4.3	70	K36900751_K0Q175
1000	96x175	1.5	50	8000	3	80	K36900102_K0R175
1000	116x125	1.2	60	4000	2.9	80	K36900102_K0T125
1100	86x250	1.2	50	7700	3	70	K36900102_K0Q250
1100	116x145	1.2	40	6600	2.5	90	K36900112_K0T145
1500	116x175	1	50	9000	2.5	100	K36900152_K0T175
2000	116x230	0.8	60	18000	2	100	K36900202_K0T230
2750	136x230	0.7	60	19250	1.8	100	K36900272_K1U230
3500	136x335	0.4	60	12250	1.2	100	K36900352_K0U335

**RATED
VOLTAGE
VDC**

900V

Cap. μF	Ø x L mm	ESR mΩ	Ls nH	I _{peak} A	R _{th} K/W	I _{rms} 10kHz 45°C A	PART NUMBER Termination digit excluded
250	76x120	4.7	60	1500	3.9	50	K36111251_K0J120
330	86x120	3.8	60	1980	3.8	60	K36111331_K0Q120
360	86x120	3.8	60	2160	3.5	50	K36111361_K0Q120
400	86x145	1.5	45	2000	2.9	70	K36111401_K0Q145
420	86x135	2.3	60	3780	4.8	65	K36111421_K0Q135
420	86x155	1.8	40	1680	4.4	80	K36111421_K0Q155
500	86x175	1.6	50	3000	2.8	70	K36111501_K0Q175
650	116x125	1.9	60	3250	2.9	60	K36111651_K0T125
680	86x225	1.8	60	4080	1.9	70	K36111681_K0Q225
730	116x150	0.8	45	2920	2.5	80	K36111731_K0T150
900	136x125	1.4	60	4050	2.5	60	K36111901_K0U125
920	116x175	1.4	60	5520	2.2	80	K36111921_K0T175
1250	116x230	1.1	60	7250	2.7	100	K36111122_K1T230
1700	136x230	0.9	60	7650	1.8	100	K36111172_K0U230
2550	136x335	0.7	60	10125	1.3	120	K36111252_K1U335

**RATED
VOLTAGE
VDC**

1100V

K36 TYPE STANDARD RATINGS

Cap. μF	Ø x L mm	ESR mΩ	Ls nH	I _{peak} A	R _{th} K/W	I _{rms} 10kHz 45°C A	PART NUMBER Termination digit excluded
220	76x120	4.9	60	1980	3.9	50	K36121221_K0J120
250	86x120	4.5	60	2250	3.6	50	K36121251_K0Q120
250	86x125	1.5	40	2000	3.3	60	K36121251_K0Q125
270	86x120	4	60	2430	3.5	50	K36121271_K0Q120
330	116x125	3.3	60	2640	3	60	K36121331_K0T125
330	86x140	4.8	80	1980	3	50	K36121331_K0Q140
420	86x175	1.8	50	2520	2.8	70	K36121421_K0Q175
470	86x225	2.5	60	2820	2.1	80	K36121471_K0Q225
500	116x130	1.6	50	3000	2.8	90	K36121501_K0T130
550	116x130	2.5	30	2475	2.8	100	K36121551_K0T130
680	116x175	1.3	50	5440	2.2	80	K36121681_K0T175
1000	136x175	1.1	50	8000	2	100	K36121102_K0U175
1000	116x230	1.3	60	7000	1.9	85	K36121102_K0T230
1200	136x230	1.2	60	7800	1.6	100	K36121122_K0U230
1800	136x335	0.9	60	9900	1.2	120	K36121182_K0U335

**RATED
VOLTAGE
VDC**

1200V

Cap. μF	Ø x L mm	ESR mΩ	Ls nH	I _{peak} A	R _{th} K/W	I _{rms} 10kHz 45°C A	PART NUMBER Termination digit excluded
90	76x95	3.3	45	1200	5.5	50	K36161900_K0J095
120	76x120	4.4	55	1200	4.8	50	K36161121_K0J120
120	86x95	2.6	45	1200	5.1	60	K36161121_K0Q095
150	76x140	4.9	55	1200	4.6	45	K36161151_K0J140
150	76x145	2.4	45	1200	4.3	70	K36161151_K0J145
170	76x175	2.5	45	2300	4.3	65	K36161171_K0J175
250	86x175	2.2	45	3300	4.4	70	K36161251_K0Q175
320	116x120	1.9	50	4280	5	70	K36161321_K0T120
420	116x175	2.1	45	6549	3.6	100	K36161421_K0T175
470	116x175	1.4	45	5640	3.4	100	K36161471_K0T175
600	116x230	1.1	50	9000	2.8	100	K36161601_K0T230
850	136x230	1.1	60	8500	2.4	120	K36161851_K0U230

**RATED
VOLTAGE
VDC**

1600V

K36 TYPE STANDARD RATINGS

Cap. μF	Ø x L mm	ESR mΩ	Ls nH	I _{peak} A	R _{th} K/W	I _{rms} 10kHz 45°C A	PART NUMBER Termination digit excluded
75	76x120	8.4	60	1200	3.9	40	K36201750_K0J120
100	86x120	6.3	60	1600	3.5	50	K36201101_K0Q120
150	86x175	2.8	50	2400	2.5	60	K36201151_K0Q175
190	116x125	3.4	60	3040	2.9	60	K36201191_K0T125
200	86x225	3.3	60	3200	3.3	60	K36201201_K0Q225
270	116x175	2.2	50	4320	3.2	70	K36201271_K0T175
280	116x175	1.5	50	4480	2.2	70	K36201281_K0T175
370	116x225	1.9	60	5920	1.9	70	K36201371_K0T225
400	136x175	1.1	50	6400	1.8	80	K36201401_K0U175
600	136x260	0.9	50	9600	1.3	100	K36201601_K0U260
800	135x335	1	60	12800	1.1	100	K36201801_K0U335

**RATED
VOLTAGE
VDC**

2000V

Cap. μF	Ø x L mm	ESR mΩ	Ls nH	I _{peak} A	R _{th} K/W	I _{rms} 10kHz 45°C A	PART NUMBER Termination digit excluded
66	86x140	4	60	1450	4.6	50	K36251660_K0Q140
130	116x140	2.6	60	3900	3.3	60	K36251131_K0T140
150	116x175	1.2	50	4500	2.9	100	K36251151_K0T175
210	116x225	1.4	60	6300	2.5	100	K36251211_K0T225
210	136x175	1.1	50	6300	2.5	100	K36251221_K0U175
290	136x225	1.3	60	8700	2.1	100	K36251291_K0U225
350	136x265	1.5	60	9800	1.9	100	K36251351_K0U265

**RATED
VOLTAGE
VDC**

2500V

Cap. μF	Ø x L mm	ESR mΩ	Ls nH	I _{peak} A	R _{th} K/W	I _{rms} 10kHz 45°C A	PART NUMBER Termination digit excluded
42	86x140	4.7	60	1470	4.7	50	K36301420_K0Q140
68	86x225	2.3	60	2380	3.2	70	K36301680_K0Q225
66	116x120	2.6	60	2310	3.6	60	K36301660_K0T120
82	116x175	5.9	60	2870	3.3	60	K36301820_K0T175
100	116x175	5.6	60	3500	2.4	50	K36301101_K0T175
120	136x175	4.3	50	4200	2.9	50	K36301121_K0U175
150	116x230	6.7	60	5250	2.9	40	K36301151_K0T230
180	136x230	5.6	60	6300	3	60	K36301181_K0U230

**RATED
VOLTAGE
VDC**

3000V

K36 TYPE STANDARD RATINGS

Cap. μF	Ø x L mm	ESR mΩ	Ls nH	Ipeak A	Rth K/W	Irms 10kHz 45°C A	PART NUMBER Termination digit excluded
42	116x130	3.7	60	2520	3.2	60	K36361420_K0Q130
60	136x130	2.7	60	3600	3.3	70	K36361600_K0U130
88	116x225	6.6	60	5280	2.5	100	K36361880_K0Q225
110	116x265	4.5	60	6600	2.2	100	K36361111_K0Q265
125	136x230	4.7	60	7500	1.5	100	K36361121_K1U230
150	136x265	2.5	60	9000	1.4	100	K36361151_K0U265

**RATED
VOLTAGE
VDC**

3600V

Cap. μF	Ø x L mm	ESR mΩ	Ls nH	Ipeak A	Rth K/W	Irms 10kHz 45°C A	PART NUMBER Termination digit excluded
24	86x140	3.9	60	1680	4.5	40	K36401240_K0Q140
38	86x225	2	60	2660	3.2	80	K36401380_K0Q225
70	116x225	3.8	60	4900	2.5	100	K36401700_K0Q225
100	136x225	4.5	60	7000	2.1	100	K36401101_K0U225
130	136x265	3.8	60	9100	1.8	100	K36401131_K0U265

**RATED
VOLTAGE
VDC**

4000V

PLEASE TO CONTACT OUR TECHNICAL SERVICE FOR MORE INFORMATION OR SPEC-IN ANALYSIS.